

Air Purifier

User Manual

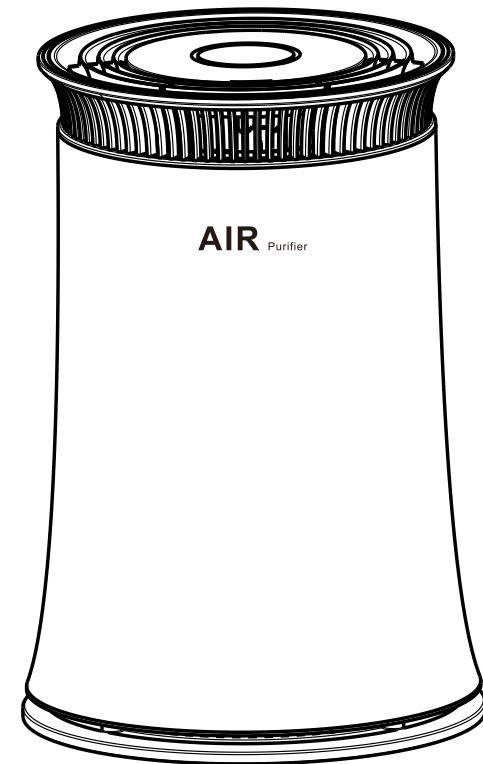

KJFC15-2 KJFC15-3

For your benefit and safety, please read this manual in details.

About this user manual

Congratulations on your purchase of this air purifier. Please study this user manual carefully to familiarize yourself with the special features and functions of your cleaner and keep it in a safe place for future reference.

Contents

Safety Instructions	2
Using Your Unit	3
Components	3
Control Panel	5
Getting Started	5
How To Use	6
Maintenance	8
Frequently Asked Questions	9
Specifications	10



Do not dispose of appliances into household waste! According to the European Directive 2002/96/EC on waste electrical and electronic equipment and its incorporation into national right, products that are no longer suitable for use must be separately collected and sent for recovery in an environmentally-friendly manner.

Specifications

Model	KJFC15
Power supply	DC24V-
Maximum power	26W
Maximum airflow rate	130m ³ /h
Noise level	Max: 55 dB(A) Min: <26 dB(A)
Energy efficiency ratio	>4.8
Dimension	8"D x 12"H
Net weight	3.74 Lbs.

Frequently Asked Questions

Phenomenon	Reason & Solution
1、Smell	<ul style="list-style-type: none"> ○The filter is too dirty because of not replacing for a long time----replace the filter ○ Use the purifier in moist conditions or make water infiltrate the filter----replace the filter ○Add some unsuitable spice into the spice box ----replace the spice box ○Reuse the filter after a long time without cleaning----replace the filter if the problem cannot be solved after cleaning ○Detect the odor of burning----stop running the purifier immediately and cut off the power; contact manufacture to repair it
2、No wind	<ul style="list-style-type: none"> ○The first gear is regarded as sleep----mode so that only a breeze of wind can be felt ○ The machine out of operation----check the power supply system; replace the power adapter or contact manufactures to service
3、Ineffectiveness	<ul style="list-style-type: none"> ○The filter no longer has any effect----replace the filter ○Use at inappropriate places, such as oversize places
4、Three gear indicator light up at the same time	<ul style="list-style-type: none"> ○Machine malfunctions----cut off the power immediately and contact manufactures to service

Safety Instructions

IMPORTANT

Please read all instructions carefully before using the purifier and follow basic safety precautions to avoid the risk of fire, electric shock or injury to persons or property.

1. Only use the supplied original power adapter with this product. If the adapter, wire or plug is damaged, return the complete product to the place of purchase for inspection, repair or replacement.
2. Switch off and unplug the device before replacing the filter.
3. Unplug the item if it will not be used for a long time.
4. Be sure that applied voltage is conformed to the voltage indicating on the adapter.
5. Do not throw rubbish into the air purifier inlet or outlet.
6. Do not block off the inlet or outlet.
7. Do not refit or disassemble the air purifier without approval.
8. Keep away from water, heat and fire.
9. Do not run the purifier without filter because inhalation of dust may cause some running problems of equipment.
10. Always operate the purifier from a power source of the same voltage, frequency and rating as indicated on the product identification plate.
11. Don't switch on the machine or pull the plug with wet hands to avoid electric shock.
12. Do not allow children to use the air purifier.
13. Keep the purifier away from children.
14. To reduce the risk of electric shock, do not expose the unit or flexible cord to moisture of any sort.
15. Switch OFF and unplug before cleaning.
16. Do not place objects on the purifier or allow objects to obstruct the inlet or outlet openings, or operate in close proximity to walls or curtains, etc.
17. This purifier is intended for normal domestic/household use only.
18. Do not attempt to disassemble the unit other than to replace filters.
19. Do not place the unit on a metal surface.
20. Do not use the purifier in artificially hot or humid conditions or allow to be used in any hazardous environment.
21. Do not clean the purifier with organic solvents.

Using Your Unit

- Less volume and greater airflow rate
- Near silent: more quiet (<26dB(A) at low speed) even than ambient noise
- Fashion styling: elegant & cozy, creating favourable environment for your bedroom and office
- More effective and cleaner: excellent airflow mate with HEPA filter, make your room far away from dust and odor
- More energy-efficient and safer : brushless DC motor

Components

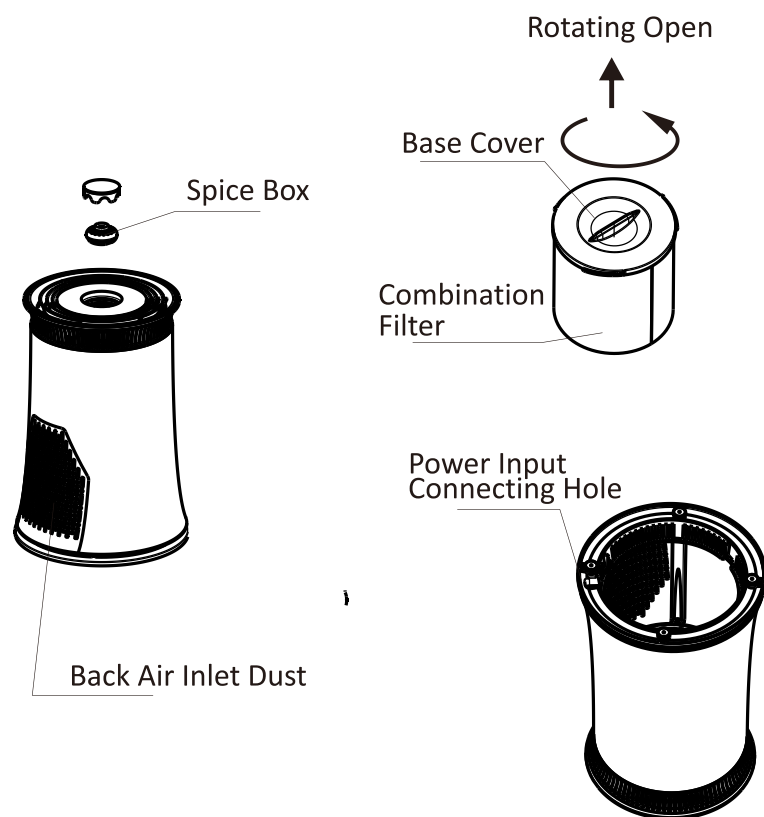

Maintenance

※Before attempting to perform any maintenance on the purifier, disconnect the power adapter!

Filter

- 1、Reference time of changing filter: about once a year
 - ※It depends on different places and usages. For example, changing time of filter may shorter in contaminated zones or smoking areas, etc.
 - ※Please change the filter if the cleaning effect is not good.
- 2、Cleanup routines: biweekly
 - ◇Use soft brush or dry cotton cloth or cleaner to clean the filter surface only.
 - ◇Do not use water to wash the filter.
 - ◇Do not force press or pull because the filter can be broken or deformed easily. Please change a new one before using if it is damaged.

Spice Box

- 1、Reference time of adding liquid spice: about once a month
 - ※Add or change liquid spice that you want if the flavor effect is not good.
 - ※Do not add different liquid spices in the same spice box.
 - ※Do not add chemical liquid spice, but add essential liquid spice.
- 2、Add Method
 - ◇Open the cover and then take the spice box out. Take care to keep the spice box flat.
 - ◇Drop essential liquid spice into the middle round entrance.
 - ◇Do not add over 2ml (6-8 drops) liquid spice into the spice box.
 - ◇Invert the spice box after 10 minutes' standing and make sure no fluid exudation before installing the spice box.
 - ※Do not put the spice box into the purifier when it stained with residual liquid.



External surface

- Please use dryness soft fabric to wipe the surface, inlets and outlets
- ※Do not use the chemical cleaning agent

Long-term idle

- Cut off the power
- Clean the surface and filter
- Store at a dry and cool place and cover with plastic bag

Lighting Control Function

Press the [LIGHT] button after startup or in other modes, indicators in the control panel air quality indicators or gear indicators can be light up or light out.

※It is advised that you can use this function at night or use this function as nightlight.

Anion

The anion generator releasing anions while motor running.
And stop while motor stop running.

Stop

Press the  button in current operational state, the motor will stop running and all indicators will light up.

Perfume Air Function

The built-in spice box makes you feel free to add any liquid spice that you want. The tailor-made wood fiber particles in the spice box help to lock the aroma, release aroma slower and keep aroma longer.

The spice box is below the upper cover so that aroma will send out while starting the purifier.



※Maximum booking shutdown time will be 8 hours.

Components

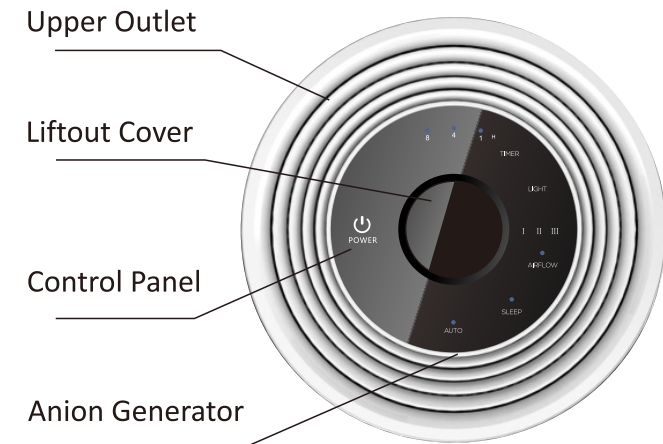

Control Panel

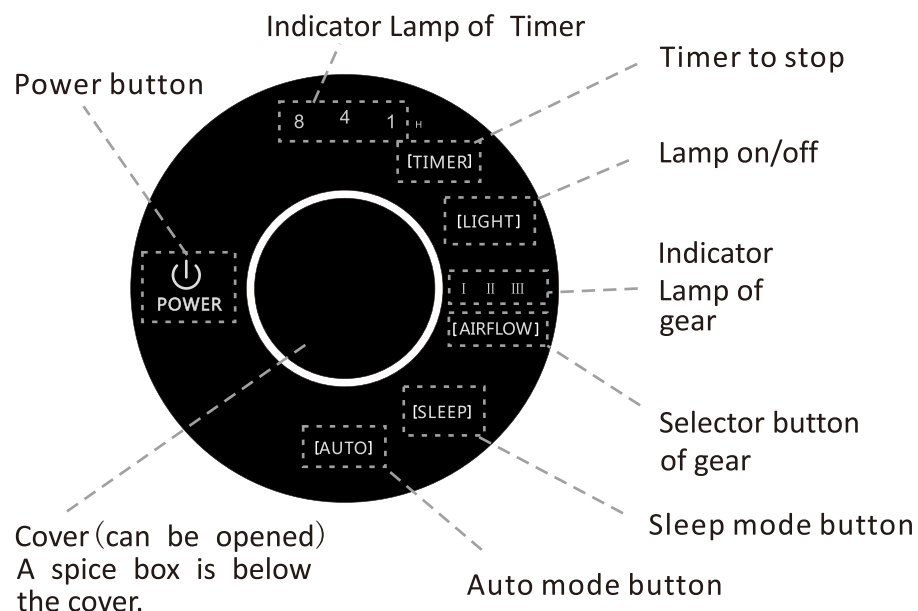

Getting Started

Invert the equipment after unpacking it.

Rotate the base cover to take out the filter by the guide arrow.

Replace the filter after opening the package. Take care to rotate the base cover in revert direction described on step2.

Pick out the power adapter and then access to the corresponding port.

Insert the plug of power adapter into the upright purifier.

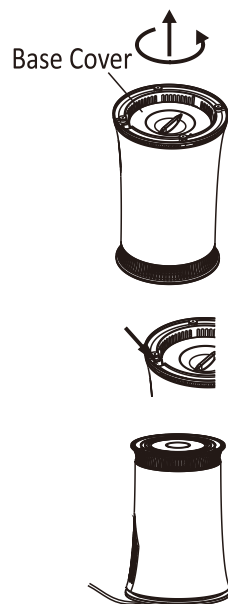

How To Use

Start

After power on, press the  button. The Ring Lamp will light up

Autorun mode

Press the [AUTO] button after startup or in other modes, it will go into the autorun mode.

At this time, the [AUTO] indicator will light and automatically adjust the gear (depends on sensor data)

And the indicator Lamp will light up, The Ring Lamp will light up in corresponding colors on the basis of air quality

Color of Ring Lamp	➤	Blue	Yellow	Red
Air quality	➤	Good	Moderate	Bad

Sleep mode

Press the [SLEEP] button after startup or in other modes, it will go into the sleep mode.

At this time, the [SLEEP] indicator will light and it will run in gear "I"

Manual mode

Press the [AIRFLOW] button after startup or in other modes, it will go into the manual mode.

At this time, the [AIRFLOW] indicator will light and it will run in gear selected

Timer Function

Press the [TIMER] button after startup or in other modes, you can set a specific time to automatically shutdown the air purifier.

When you press the button, indicator on control panel will light up